



# XP Series

## 100% 8 HOUR CHARGER

### High Efficiency charging solutions!

No charger is safer for your battery fleet.

## USA Made!

Although ferroresonant technology has been around for many years, improvements are constantly being made and today, our charger boasts a high efficiency, 87% and power factor > 90% close to that of other manufacturers high frequency chargers. Sophisticated charge control monitors the battery throughout charge and delivers a safe, complete charge to keep your fleet healthy and running!

LATEST TECHNOLOGY!

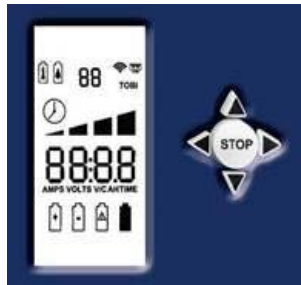

P46-301 Control Icon and Alpha-numeric display

INTELENT CHARGING

Constant communication between battery and charger for perfect charge every time.

Graphic Icon display allows quick identification of charge status and “ready” battery.

Underwrites Labs and ULc listed.

BENEFITS

Completely charges a 100% discharged battery in 8 hours or less.

Trustworthy ferroresonant technology.

Easy field maintenance—non proprietary.

Lowest cost of ownership.

Long operating life 10+ years with 5+5 year warranty.

Rugged industrial 16 ga. steel cabinet.

Available in every AC voltage , single and three phase

“Smart” Charge Control with Icon and digital display.

Failsafe charge for your battery.

Fully automatic.

Easy access to tap settings for quick changeover

FEATURES



Phone: 314-739-1414  
Fax: 314-739-1277  
E-mail: sales@chargingti.com  
www.chargingti.com

Charging Technologies Inc  
4328 Bridgeton Industrial Drive  
Bridgeton, Missouri 63044

SINGLE PHASE										THREE PHASE					
Cell	Amp hr.	Range	Model	DC Amp	AC Input Amps				Case	Model	DC Amp	AC Input Amps			
	Rating			Output	120	208	240	480			Output	208	240	480	600
6	260	181-260	XPS6-260*	47	6.6	3.8	3.3	1.6	500						
6	380	261-380	XPS6-380*	69	9.7	5.6	4.8	2.4	500	XPT6-380*	69	3.2	2.8	1.4	1.1
6	475	381-475	XPS6-475*	86	12	6.9	6	3	500	XPT6-475*	86	4	3.5	1.7	1.4
6	600	476-600	XPS6-600*	108	15.1	8.7	7.6	3.8	500	XPT6-600*	108	5	4.4	2.2	1.8
6	750	601-750	XPS6-750*	135	18.9	10.9	9.5	4.7	500	XPT6-750*	135	6.3	5.5	2.7	2.2
6	865	751-865	XPS6-865*	156	21.8	12.6	10.9	5.5	501	XPT6-865*	156	7.3	6.3	3.2	2.6
										XPT6-965*	174	8.1	7	3.5	2.8
										XPT6-1050*	189	8.8	7.6	3.8	3.0
12	180	01-180	XPS12-180*	33	9.2	5.3	4.6	2.3	500						
12	260	181-260	XPS12-260*	47	13.2	7.6	6.6	3.3	500						
12	380	261-380	XPS12-380*	69	19.3	11.1	9.7	4.8	500	XPT12-380*	69	6.4	5.6	2.8	2.2
12	475	381-475	XPS12-475*	86	24.1	13.9	12	6	500	XPT12-475*	86	8	7	3.5	2.8
12	600	476-600	XPS12-600*	108	30.2	17.4	15.1	7.6	501	XPT12-600*	108	10.1	8.7	4.4	3.5
12	750	601-750	XPS12-750*	135	37.8	21.8	18.9	9.5	501	XPT12-750*	135	12.6	10.9	5.5	4.4
12	865	751-865	XPS12-865*	156	43.7	25.2	21.8	10.9	501	XPT12-865*	156	14.6	12.6	6.3	5.0
12	965	866-965	XPS12-965*	174	-	28.1	24.4	12.2	501	XPT12-965*	174	16.2	14.1	7	5.6
										XPT12-1050*	189	17.6	15.3	7.6	6.1
										XPT12-1200*	216	20.2	17.5	8.7	7.0
										XPT12-1450*	261	24.4	21.1	10.6	8.5
18	260	181-260	XPS18-260*	47	19.7	11.4	9.9	4.9	500						
18	380	261-380	XPS18-380*	69	30	16.7	14.5	7.2	500	XPT18-380*	69	9.7	8.4	4.2	3.4
18	475	381-475	XPS18-475*	86	36.1	20.8	18.1	9	500	XPT18-475*	86	12	10.4	5.2	4.2
18	600	476-600	XPS18-600*	108	45.4	26.2	22.7	11.3	501	XPT18-600*	108	15.1	13.1	6.6	5.3
18	750	601-750	XPS18-750*	135	-	32.7	28.4	14.2	501	XPT18-750*	135	18.9	16.4	8.2	6.6
18	865	751-865	XPS18-865*	156	-	37.8	32.8	16.4	501	XPT18-865*	156	21.8	18.9	9.5	7.6
18	965	866-965	XPS18-965*	174	-	42.2	36.5	18.3	501	XPT18-965*	174	24.4	21.1	10.6	8.5
18	1050	966-1050								XPT18-1050*	189	26.5	22.9	11.5	9.2
18	1200	1051-1200								XPT18-1200*	216	30.3	26.2	13.1	10.5
18	1450	1201-1450								XPT18-1450*	261	36.6	31.7	15.8	12.6
24	180	01-180	XPS24-180*	33	18.5	10.7	9.2	4.6	500						
24	260	181-260	XPS24-260*	47	26.3	15.2	13.2	6.6	500						
24	380	261-380	XPS24-380*	69	38.6	22.3	19.3	9.7	501	XPT24-380*	69	12.9	11.2	5.6	4.5
24	475	381-475	XPS24-475*	86	48.2	27.8	24.1	12	501	XPT24-475*	86	16.1	13.9	7	5.6
24	600	476-600	XPS24-600*	108	-	34.9	30.2	15.1	501	XPT24-600*	108	20.2	17.5	8.7	7.0
24	750	601-750	XPS24-750*	135	-	43.6	37.8	18.9	501	XPT24-750*	135	25.2	21.8	10.9	8.7
24	865	751-865	XPS24-865*	156	-	-	43.7	21.8	501	XPT24-865*	156	29.1	25.2	12.6	10.1
24	965	866-965	XPS24-965*	174	-	-	-	24.4	501	XPT24-965*	174	32.5	28.2	14.1	11.3
24	1050	966-1050								XPT24-1050*	189	35.3	30.6	15.3	12.2
24	1200	1051-1200								XPT24-1200*	216	40.3	35	17.5	14.0
24	1450	1201-1450								XPT24-1450*	261	-	42.2	21.1	16.9
40	475	381-475								XPT40-475*	86	26.8	23.2	11.6	9.3
40	600	476-600								XPT40-600*	108	33.6	29.1	14.6	11.7
40	750	601-750								XPT40-750*	135	42	36.4	18.2	14.6
40	865	751-865								XPT40-865*	156	-	42.1	21	16.8
40	965	866-965								XPT40-965*	174	-	46.9	23.5	18.8

\* Requires AC voltage code

				CASE DIMENSIONS					
AC Voltage	1Φ	3Φ	CASE #	HEIGHT		WIDTH		DEPTH	
				IN	CM	IN	CM	IN	CM
120/208/240	A	N/A							
208/240/480	B	B	500	20.50	52.00	17.30	44.00	14.80	37.60
480/575	K	K	501	26.00	66.00	24.30	61.70	24.60	65.50
600	AG	AG	502	28.00	71.10	38.30	97.20	27.60	70.10

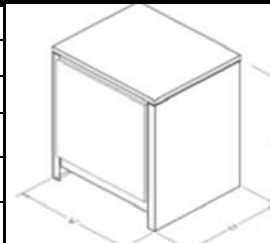

Phone: 314-739-1414  
 Fax: 314-739-1277  
 E-mail: sales@chargingti.com  
 www.chargingti.com

Charging Technologies Inc  
 4328 Bridgeton Industrial Drive  
 Bridgeton, Missouri 63044